

ENTRANCE WORKS

Notes:
All measurements, heights, areas, levels, and structural details to be checked and verified by the contractor and Architect/Engineer prior to commencement of any works or agreements
Do not scale any drawing. Work to figured dimensions only

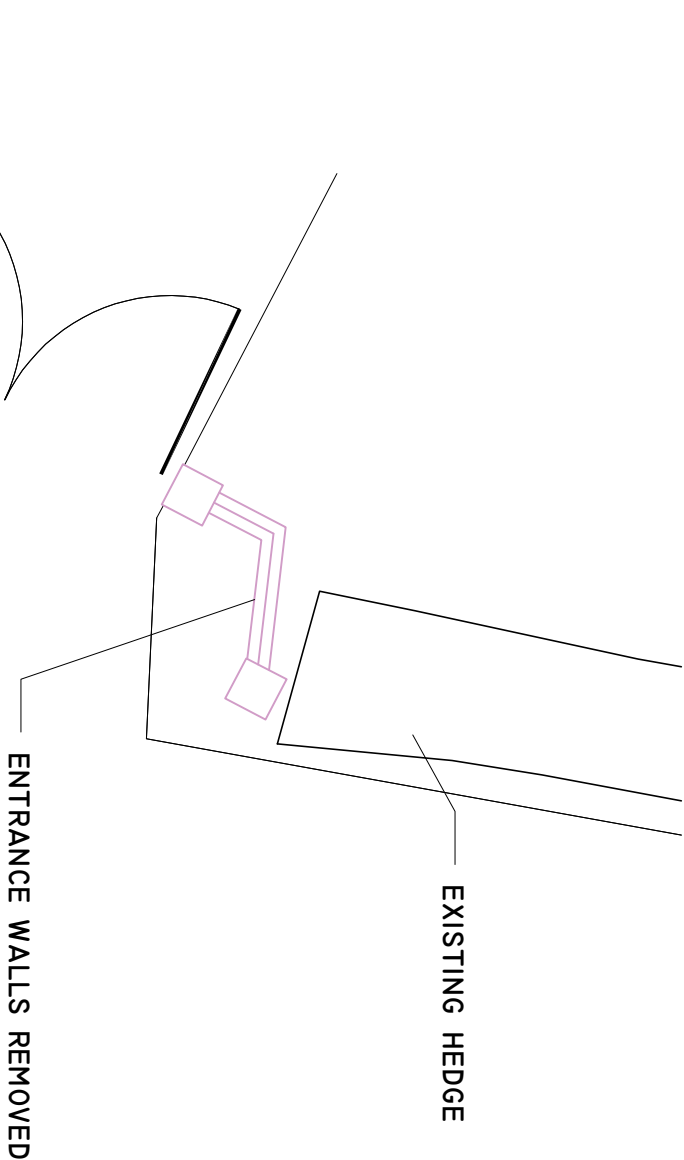

/ED



ORG ENTRANCE GATE – ONE OF THE CONCRETE PIERS REMOVED TO GAIN ACCESS

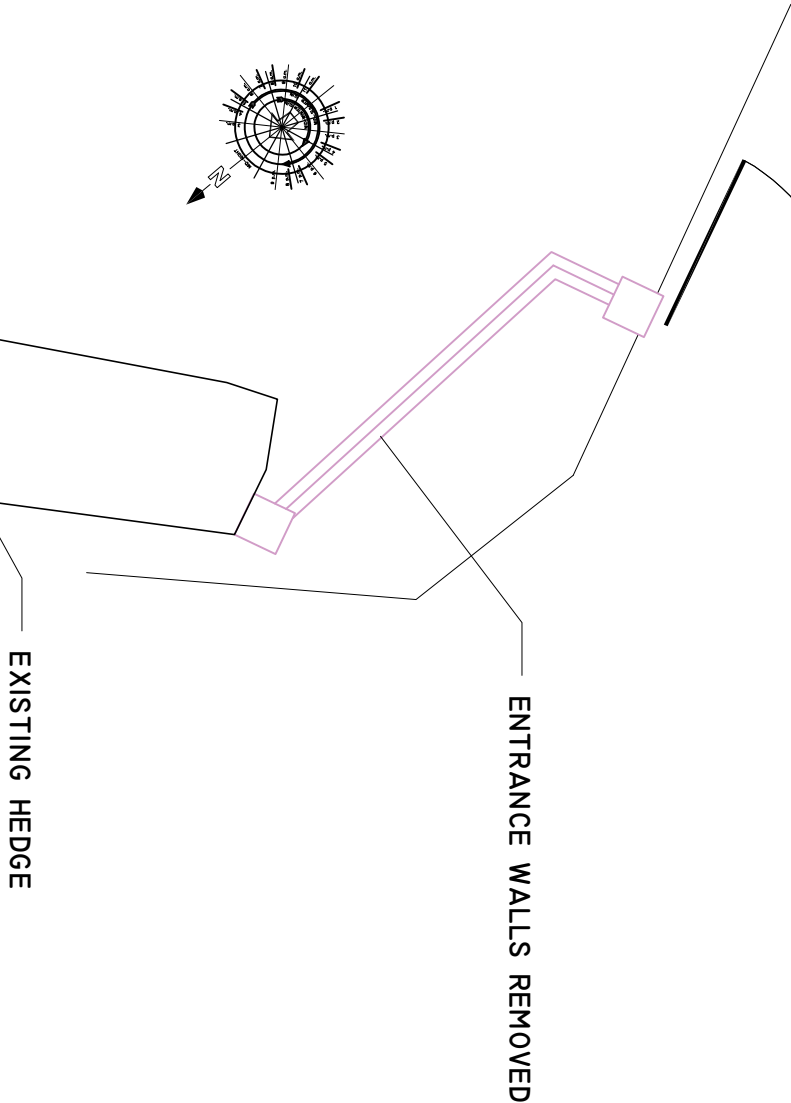

"Copyright and ownership of this drawing is vested in OA Design Ltd (via Will Design Associates whose written prior consent is required for its use, reproduction or for publication to any third party. All rights reserved by the law of copyright and by international copyright conventions are reserved to OA Design Ltd and may be protected by court proceedings for damages and/or injunctions and costs."

A3

WILL DESIGN ASSOCIATES

DESIGN & PROJECT MANAGEMENT CONSULTANTS

KNOCKMARTIN LANE, LONGFORD

Tel (043) 33 48 551

Mbl (086) 875 36 15

bquaine@gmail.com

PROJECT

SUBSTITUTE CONSENT
UPGRADE OF EXISTING DWELLING INCLUDING:
1. RE-FENCING OF LANDS,
2. WIDENING OF EXISTING ENTRANCE GATE,
3. RESURFACING OF EXISTING DRIVEWAY
4. WORKS TO HARBOUR
WITHIN SAC AND PNHA AT CASHEL, NEWTOWNCASHEL, CO. LONGFORD
FOR MR. JOE SHEAHAN

DATE	SCALE	REV.	JOB NO.	DRWG NO.
30.05.24	1:100'		21102	P04
DRWG TITLE: ENTRANCE DEMOLITION WORKS				

